

[MY ACCOUNT](#) [BLOG](#)[0 \\$ 00.00](#)[Home](#) > [Steel Adapters](#) > [37 Degree JIC](#) >

306 -37° JIC BULKHEAD LOCKNUT



37° JIC Bulkhead Locknut

306 JIC equivalent to the following:

- * SAE 070118
- * Parker 53N
- * Parker Hydraulics WLN
- * Weatherhead C5924
- * Aeroquip 210212

Available in stainless steel: SS-306

JIC 37 Bulkhead Locknut



Alternative Views:

PRESSURE
RATINGSDIMENSIONAL
DRAWINGSCROSS
REFERENCE

37° JIC BULKHEAD LOCKNUT

[PRINT PAGE](#)

ITEM#	ITEM NAME	OUR PRICE	QTY	
306-02	306-02 Bulkhead Locknut, 1/8" JIC (5/16"-24 thread)	\$1.70		
306-03	306-03 Bulkhead Locknut, 3/16" JIC (3/8"-24 thread)	\$1.47		
306-04	306-04 Bulkhead Locknut, 1/4" JIC (7/16"-20 thread)	\$0.49		
306-05	306-05 Bulkhead Locknut, 5/16" JIC (1/2"-20)	\$0.44		
306-06	306-06 Bulkhead Locknut, 3/8" JIC (9/16"-18 thread)	\$0.42		

306-08	306-08 Bulkhead Locknut, 1/2" JIC (3/4"-16 thread)	\$0.51		
306-10	306-10 Bulkhead Locknut, 5/8" JIC (7/8"-14 thread)	\$0.66		
306-12	306-12 Bulkhead Locknut, 3/4" JIC (1 1/16"-12 thread)	\$1.39		
306-14	306-14 Bulkhead Locknut, 7/8" JIC (1 3/16"-12 thread)	\$1.14		
306-16	306-16 Bulkhead Locknut, 1" JIC (1 5/16"-12 thread)	\$1.21		
306-20	306-20 Bulkhead Locknut, 1-1/4" JIC (1-5/8"-12 thread)	\$1.66		
306-24	306-24 Bulkhead Locknut, 1-1/2" JIC (1 7/8"-12 thread)	\$2.71		
306-32	306-32 Bulkhead Locknut, 2" JIC (2 1/2"-12 thread)	\$19.12		

Check the items you wish to purchase, then click

ADD TO CART

Features

Material: High pressure carbon steel with zinc trivalent anti-corrosion coating SAE 37° JIC meets SAE J514 specifications and are used for petroleum and mineral oil based fluids in hydraulic applications

Product Details

Pressure Ratings:

SAE J514 Pressure Ratings					
Nom. SAE Dash Size	Nom. Tube O.D. Inches	37 Degree Flare Straight Thread	Nom. Pipe Size	SAE St. Threads Union & Bulkhead (PSI)	Fittings With Pipe Threads (PSI)
2	1/8	5/16"-24	1/8"	5000	5000
3	3/16	3/8"-24	1/8"	5000	5000
4	1/4	7/16"-20	1/8"	5000	5000
5	5/16	1/2"-20	1/8"	5000	5000
6	3/8	9/16"-18	1/4"	5000	5000

8	1/2	3/4"-16	3/8"	4500	4000
10	5/8	7/8"-14	1/2"	3500	3000
12	3/4	1 1/16"-12	3/4"	3500	3000
14	7/8	1 3/16"-12	3/4"	3000	2500
16	1	1 5/16"-12	1"	3000	2000
20	1 1/4	1 5/8"-12	1 1/4"	2500	1150
24	1 1/2	1 7/8"-12	1 1/2"	2000	1000
32	2	2 1/2"-12	2"	1500	1000

NOTE: Since many factors influence the pressure at which a system will or will not perform satisfactory, values shown in this table should not be construed as guaranteed minimum.

Dimensional Drawings:

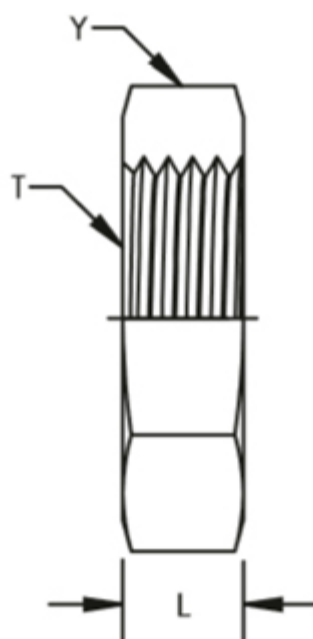

Product ID	Y HEX	T	L
SS-306-02	0.563	5/16-24	0.22
SS-306-03	0.625	3/8-24	0.22
SS-306-04	0.688	7/16-20	0.28
SS-306-05	0.75	1/2-20	0.28
SS-306-06	0.813	9/16-18	0.27
SS-306-08	1	3/4-16	0.31
SS-306-10	1.125	7/8-14	0.36
SS-306-12	1.375	1-1/16-12	0.41
SS-306-14	1.5	1-3/16-12	0.41
SS-306-16	1.625	1-5/16-12	0.41

SS-306-20	1.875	1-5/8-12	0.41
SS-306-24	2.125	1-7/8-12	0.41
SS-306-32	2.75	2-1/2-12	0.41

Competitor Cross Reference:

INTERCHANGEABLE WITH:					
ITEM #	AEROQUIP	PARKER	SSP	SAE	MS
306-LN-02	259-210212-2	2 WLN-SS	2BN	70118	MS51860
306-LN-03	259-210212-3	3 WLN-SS	3BN	70118	MS51860
306-LN-04	259-210212-4	4 WLN-SS	4BN	70118	MS51860
306-LN-06	259-210212-6	6 WLN-SS	6BN	70118	MS51860
306-LN-08	259-210212-8	8 WLN-SS	8BN	70118	MS51860
306-LN-10	259-210212-10	10 WLN-SS	10BN	70118	MS51860
306-LN-12	259-210212-12	12 WLN-SS	12BN	70118	MS51860
306-LN-16	259-210212-16	16 WLN-SS	16BN	70118	MS51860
306-LN-20	259-210212-20	20 WLN-SS	20BN	70118	MS51860
306-LN-24	259-210212-24	24 WLN-SS	24BN	70118	MS51860
306-LN-32	259-210212-32	32 WLN-SS	32BN	70118	MS51860

Share your knowledge of this product. Be the first to write a review »

ABOUT US

- Company Info
- Contact Us
- Careers
- Reference Center

MY ACCOUNT

- View Cart
- Sign-In
- Order Status

PRODUCTS

- Product Index
- Category Index

HELPFUL INFO

- Shipping & Returns
- Privacy Policy
- Terms & Conditions
- Warranty

QUESTIONS? CALL OR TEXT US!

Tel: (866) 620-7320
 Email: sales@hydraulicsdirect.com

Copyright 52565 Hydraulics Direct

FOLLOW US

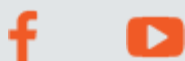

TRUSTED SELLER

