



MY ACCOUNT BLOG

0 \$ 00.00

Home > Steel Adapters > 37 Degree JIC >

2404L -37° MALE JIC X LONG MALE NPTF PIPE CONNECTOR



(1) JIC Male, (2) NPTF Male



Alternative Views:



37° Male JIC x Long Male NPTF Pipe Connector

2404L JIC equivalent to the following:

- * SAE 070102
- * Parker Hydraulics FFTX
- * Aeroquip 202113

Available in stainless steel: SS-2404 L



PRESSURE RATINGS



DIMENSIONAL DRAWINGS



CROSS REFERENCE

37° MALE JIC X LONG MALE NPTF PIPE CONNECTOR

PRINT PAGE

| ITEM# | ITEM NAME | OUR PRICE | QTY | |
|-------------|---|-----------|-----|--|
| 2404L-04-02 | 2404L-04-02 - 1/4" JIC (7/16"-20 thread) x 1/8" NPTF Male, Long | \$7.49 | | |
| 2404L-04-04 | 2404L-04-04 - 1/4" JIC (7/16"-20 thread) x 1/4" NPTF Male, Long | \$7.69 | | |
| 2404L-05-04 | 2404L-05-04 - 5/16" JIC (1/2"-20) x 1/4" NPTF Male, Long | \$13.97 | | |
| 2404L-06-04 | 2404L-06-04 - 3/8" JIC (9/16"-18 thread) x 1/4" NPTF Male, Long | \$9.45 | | |
| 2404L-06-06 | 2404L-06-06 - 3/8" JIC (9/16"-18 thread) x 3/8" NPTF Male, Long | \$7.22 | | |

| | | | | |
|-------------|---|----------------|--|--|
| 2404L-08-06 | 2404L-08-06 - 1/2" JIC (3/4"-16 thread) x 3/8" NPTF Male, Long | \$10.26 | | |
| 2404L-12-12 | 2404L-12-12 - 3/4" JIC (1 1/16"-12 thread) x 3/4" NPTF Male, Long | \$24.68 | | |
| 2404L-16-16 | 2404L-16-16 - 1" JIC (1 5/16"-12 thread) x 1" NPTF Male, Long | \$17.77 | | |

Check the items you wish to purchase, then click

ADD TO CART

Features

Material: High pressure carbon steel with zinc trivalent anti-corrosion coating SAE 37° JIC meets SAE J514 specifications and are used for petroleum and mineral oil based fluids in hydraulic applications

Product Details

Pressure Ratings:

| SAE J514 Pressure Ratings | | | | | |
|---------------------------|-----------------------|---------------------------------|----------------|--|----------------------------------|
| Nom. SAE Dash Size | Nom. Tube O.D. Inches | 37 Degree Flare Straight Thread | Nom. Pipe Size | SAE St. Threads Union & Bulkhead (PSI) | Fittings With Pipe Threads (PSI) |
| 2 | 1/8 | 5/16"-24 | 1/8" | 5000 | 5000 |
| 3 | 3/16 | 3/8"-24 | 1/8" | 5000 | 5000 |
| 4 | 1/4 | 7/16"-20 | 1/8" | 5000 | 5000 |
| 5 | 5/16 | 1/2"-20 | 1/8" | 5000 | 5000 |
| 6 | 3/8 | 9/16"-18 | 1/4" | 5000 | 5000 |
| 8 | 1/2 | 3/4"-16 | 3/8" | 4500 | 4000 |
| 10 | 5/8 | 7/8"-14 | 1/2" | 3500 | 3000 |
| 12 | 3/4 | 1 1/16"-12 | 3/4" | 3500 | 3000 |
| 14 | 7/8 | 1 3/16"-12 | 3/4" | 3000 | 2500 |
| 16 | 1 | 1 5/16"-12 | 1" | 3000 | 2000 |
| 20 | 1 1/4 | 1 5/8"-12 | 1 1/4" | 2500 | 1150 |
| 24 | 1 1/2 | 1 7/8"-12 | 1 1/2" | 2000 | 1000 |
| 32 | 2 | 2 1/2"-12 | 2" | 1500 | 1000 |

NOTE: Since many factors influence the pressure at which a system will or will not perform satisfactory, values shown in this table should not be construed as guaranteed minimum.

Dimensional Drawings:

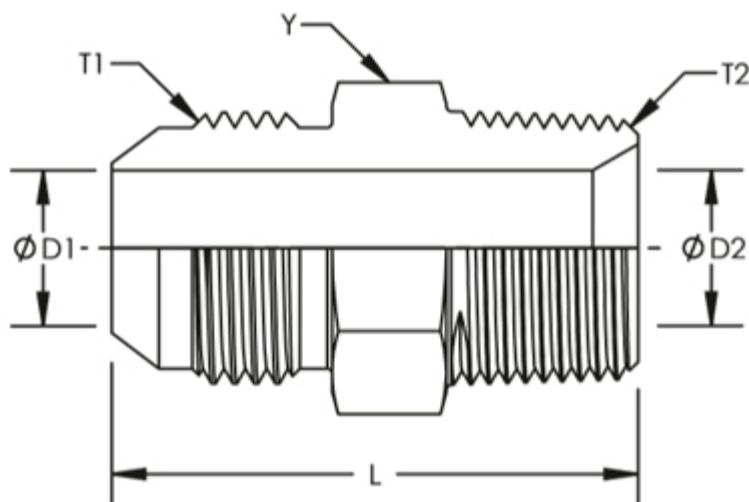

| | | B | A | L20 | T20 Ref. | C | D | D1 |
|--------------|---------|-----------|--------------|------|----------|------|------|------|
| Part Number | TUBE OD | UN/UNF-2A | NPTF | | | | | |
| 2404-L-4-2 | 1/4 | 7/16-20 | 1/8-27 | 1.81 | 0.88 | 0.5 | 0.17 | 0.19 |
| 2404-L-4-4 | 1/4 | 7/16-20 | 1/4-18 | 2.25 | 1.14 | 0.56 | 0.17 | 0.28 |
| 2404-L-5-4 | 5/16 | 1/2-20 | 1/4-18 | 2.25 | 1.14 | 0.56 | 0.23 | 0.28 |
| 2404-L-6-4 | 3/8 | 9/16-18 | 1/4-18 | 2.25 | 1.13 | 0.63 | 0.3 | 0.28 |
| 2404-L-6-6 | 3/8 | 9/16-18 | 3/8-18 | 2.5 | 1.38 | 0.75 | 0.3 | 0.41 |
| 2404-L-8-6 | 1/2 | 3/4-16 | 3/8-18 | 2.75 | 1.53 | 0.81 | 0.39 | 0.41 |
| 2404-L-8-8 | 1/2 | 3/4-16 | 1/2-14 | 3.03 | 1.63 | 0.88 | 0.39 | 0.53 |
| 2404-L-10-8 | 5/8 | 7/8-14 | 1/2-14 | 3.13 | 1.62 | 0.94 | 0.48 | 0.53 |
| 2404-L-12-12 | 3/4 | 1 1/16-12 | 3/4-14 | 3.5 | 1.89 | 1.13 | 0.61 | 0.72 |
| 2404-L-16-16 | 1 | 1 5/16-12 | 1-11 1/2 | 4 | 2.15 | 1.38 | 0.84 | 0.94 |
| 2404-L-20-20 | 1 1/4 | 1 5/8-12 | 1 1/4-11 1/2 | 4.5 | 2.57 | 1.69 | 1.08 | 1.25 |

Competitor Cross Reference:

| INTERCHANGEABLE WITH: | |
|-----------------------|------------|
| Aeroquip # | Parker # |
| 202113-2-4S | 4 FFTX-S |
| 202113-4-4S | 4-4 FFTX-S |
| 202113-4-5S | 5-4 FFTX-S |

| | |
|---------------|------------|
| 202113-4-6S | 6 FFTX-S |
| 202113-6-6S | 6-6 FFTX-S |
| 202113-6-8S | 8 FFTX-S |
| 202113-8-8S | 8-8 FFTX-S |
| 202113-8-10S | 10 FFTX-S |
| 202113-12-12S | 12 FFTX-S |
| 202113-16-16S | 16 FFTX-S |
| 202113-20-20S | 20 FFTX-S |

Share your knowledge of this product. Be the first to write a review »

ABOUT US

Company Info
 Contact Us
 Careers
 Reference Center

MY ACCOUNT

View Cart
 Sign-In
 Order Status

PRODUCTS

Product Index
 Category Index

HELPFUL INFO

Shipping & Returns
 Privacy Policy
 Terms & Conditions
 Warranty

QUESTIONS? CALL OR TEXT US!

Tel: (866) 620-7320
 Email:
 sales@hydraulicsdirect.com

Copyright 52540 Hydraulics Direct

FOLLOW US

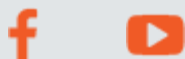

TRUSTED SELLER

