

[MY ACCOUNT](#)[BLOG](#)

0 \$ 00.00

[Home](#) > [Steel Adapters](#) > [Pipe Female Swivel \(NPSM\)](#) >

## 1404 -NPTF PIPE MALE X NPSM PIPE FEMALE SWIVEL



### NPTF Pipe Male x NPSM Pipe Swivel Female Steel Adapter

1404 adapter fittings are equivalent to the following:

- \* SAE 140130
- \* Parker Hydraulics 0107
- \* Weatherhead 9205
- \* Aeroquip 2045

Available in stainless steel: SS-1404

(1) NPTF Male (2) NPSM Swivel Female



Alternative Views:



PRESSURE RATINGS



DIMENSIONAL DRAWINGS



CROSS REFERENCE

## NPTF PIPE MALE X NPSM PIPE FEMALE SWIVEL

[PRINT PAGE](#)

ITEM#	ITEM NAME	OUR PRICE	QTY	
1404-02-02	1404-02-02 - 1/8" NPTF Male x 1/8" NPSM Swivel	<b>\$1.96</b>		
1404-02-04	1404-02-04 - 1/8" NPTF Male x 1/4" NPSM Swivel	<b>\$1.49</b>		
1404-04-02	1404-04-02 - 1/4" NPTF Male x 1/8" NPSM Swivel	<b>\$1.44</b>		
1404-04-04	1404-04-04 - 1/4" NPTF Male x 1/4" NPSM Swivel	<b>\$1.82</b>		

1404-04-06	1404-04-06 - 1/4" NPTF Male x 3/8" NPSM Swivel	<b>\$1.60</b>		
1404-04-08	1404-04-08 - 1/4" NPTF Male x 1/2" NPSM Swivel	<b>\$3.22</b>		
1404-06-04	1404-06-04 - 3/8" NPTF Male x 1/4" NPSM Swivel	<b>\$2.01</b>		
1404-06-06	1404-06-06 - 3/8" NPTF Male x 3/8" NPSM Swivel	<b>\$1.92</b>		
1404-06-08	1404-06-08 - 3/8" NPTF Male x 1/2" NPSM Swivel	<b>\$2.15</b>		
1404-08-04	1404-08-04 - 1/2" NPTF Male x 1/4" NPSM Swivel	<b>\$2.68</b>		
1404-08-06	1404-08-06 - 1/2" NPTF Male x 3/8" NPSM Swivel	<b>\$2.33</b>		
1404-08-08	1404-08-08 - 1/2" NPTF Male x 1/2" NPSM Swivel	<b>\$2.69</b>		
1404-08-12	1404-08-12 - 1/2" NPTF Male x 3/4" NPSM Swivel	<b>\$4.07</b>		
1404-12-08	1404-12-08 - 3/4" NPTF Male x 1/2" NPSM Swivel	<b>\$3.26</b>		
1404-12-12	1404-12-12 - 3/4" NPTF Male x 3/4" NPSM Swivel	<b>\$3.24</b>		
1404-12-16	1404-12-16 - 3/4" NPTF Male x 1" NPSM Swivel	<b>\$7.04</b>		
1404-16-12	1404-16-12 - 1" NPTF Male x 3/4" NPSM Swivel	<b>\$6.42</b>		
1404-16-16	1404-16-16 - 1" NPTF Male x 1" NPSM Swivel	<b>\$6.83</b>		
1404-16-20	1404-16-20 - 1" NPTF Male x 1-1/4" NPSM Swivel	<b>\$11.04</b>		
1404-20-16	1404-20-16 - 1-1/4" NPTF Male x 1" NPSM Swivel	<b>\$14.97</b>		
1404-20-20	1404-20-20 - 1-1/4" NPTF Male x 1-1/4" NPSM Swivel	<b>\$10.85</b>		
1404-20-24	1404-20-24 - 1-1/4" NPTF Male x 1-1/2" NPSM Swivel	<b>\$18.25</b>		
1404-24-20	1404-24-20 - 1-1/2" NPTF Male x 1-1/4" NPSM Swivel	<b>\$23.85</b>		
1404-24-24	1404-24-24 - 1-1/2" NPTF Male x 1-1/2" NPSM Swivel	<b>\$14.17</b>		
1404-32-32	1404-32-32 - 2" NPTF Male x 2" NPSM Swivel	<b>\$24.91</b>		

Check the items you wish to purchase, then click

ADD TO CART

## Features

Material: High pressure carbon steel with zinc trivalent anti-corrosion coating National Pipe Straight Mechanical NPSM mates with NPTF pipe fittings and adapters. Female NPSM fittings have a straight thread and 30° seat which creates a metal to metal connection in hydraulic applications

## Product Details

### Pressure:

NPT PRESSURE RATINGS, ANSI/ASME B 31.3

SIZE DESIGNATOR	NPT SIZE	MALE		FEMALE	
		PSIG	BAR	PSIG	BAR
1	1/16	11000	757	6700	461
2	1/8	10000	689	6500	447
4	1/4	8000	551	6600	454
6	3/8	7800	537	5300	365
8	1/2	7700	530	4900	337
12	3/4	7300	502	4600	316
16	1	5300	365	4400	303
20	1 1/4	6000	413	5000	344
24	1 1/2	5000	344	4600	316
32	2	3900	268	3900	268

### Dimensional Drawings:

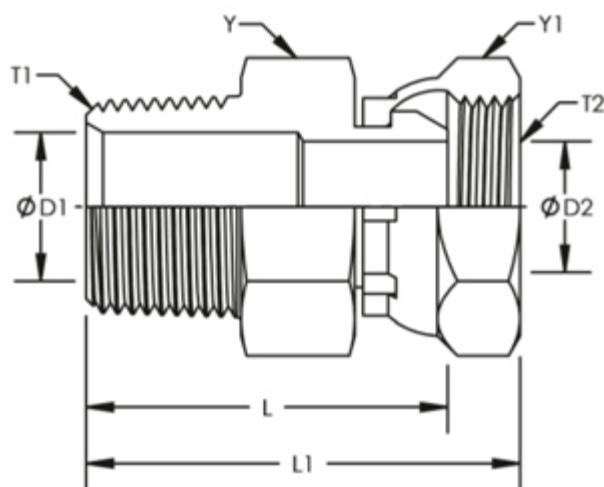

Product ID	Y HEX	Y1 HEX	T1	D1	T2	D2	L	L1
SS-1404-02-02	0.563	0.563	1/8-27	0.188	1/8-27	0.15	0.94	1.08
SS-1404-02-04	0.688	0.688	1/8-27	0.188	1/4-18	0.22	1.05	1.24
SS-1404-04-02	0.688	0.563	1/4-18	0.281	1/8-27	0.15	1.18	1.32
SS-1404-04-04	0.688	0.688	1/4-18	0.281	1/4-18	0.22	1.23	1.42
SS-1404-04-06	0.813	0.875	1/4-18	0.281	3/8-18	0.34	1.31	1.52
SS-1404-04-08	1	1	1/4-18	0.281	1/2-14	0.46	1.42	1.7
SS-1404-06-04	0.75	0.688	3/8-18	0.406	1/4-18	0.22	1.3	1.49
SS-1404-06-06	0.875	0.875	3/8-18	0.406	3/8-18	0.34	1.3	1.52
SS-1404-06-08	1	1	3/8-18	0.406	1/2-14	0.46	1.42	1.7
SS-1404-08-04	0.875	0.688	1/2-14	0.531	1/4-18	0.22	1.52	1.71
SS-1404-08-06	0.875	0.875	1/2-14	0.531	3/8-18	0.34	1.56	1.77
SS-1404-08-08	1	1	1/2-14	0.531	1/2-14	0.46	1.61	1.89
SS-1404-08-12	1.25	1.25	1/2-14	0.531	3/4-14	0.635	1.74	2.09
SS-1404-12-06	1.125	0.875	3/4-14	0.719	3/8-18	0.34	1.56	1.77
SS-1404-12-08	1.125	1	3/4-14	0.719	1/2-14	0.46	1.65	1.93
SS-1404-12-12	1.25	1.25	3/4-14	0.719	3/4-14	0.635	1.75	2.1
SS-1404-12-16	1.5	1.5	3/4-14	0.719	1-11-1/2	0.831	1.81	2.16
SS-1404-12-20	1.875	1.875	3/4-14	0.719	1-1/4-11-1/2	1.087	1.86	2.28
SS-1404-16-06	1.375	0.875	1-11-1/2	0.938	3/8-18	0.34	1.81	2.02
SS-1404-16-12	1.5	1.25	1-11-1/2	0.938	3/4-14	0.635	1.94	2.29
SS-1404-16-16	1.5	1.5	1-11-1/2	0.938	1-11-1/2	0.831	2	2.35
SS-1404-16-20	1.875	1.875	1-11-1/2	0.938	1-1/4-11-1/2	1.087	2.05	2.47

SS-1404-16-24	2.125	2.125	1-11-1/2	0.938	1-1/2-11-1/2	1.317	2.21	2.63
SS-1404-20-16	1.875	1.5	1-1/4-11-1/2	1.25	1-11-1/2	0.831	2.05	2.4
SS-1404-20-20	1.875	1.875	1-1/4-11-1/2	1.25	1-1/4-11-1/2	1.087	2.1	2.52
SS-1404-20-24	2.125	2.125	1-1/4-11-1/2	1.25	1-1/2-11-1/2	1.317	2.09	2.51
SS-1404-24-20	2.125	1.875	1-1/2-11-1/2	1.5	1-1/4-11-1/2	1.087	2.12	2.54
SS-1404-24-24	2.125	2.125	1-1/2-11-1/2	1.5	1-1/2-11-1/2	1.317	2.27	2.69
SS-1404-32-32	2.625	2.625	2-11-1/2	1.938	2-11-1/2	1.802	2.37	2.79

## Competitor Cross Reference:

INTERCHANGEABLE WITH COMPETITOR PART NUMBERS				
SHF	AEROQUIP	PARKER	SSP	SAE
1404-04-04	259-2045-4-4	0107-4-4-SS	PS4-4C	140130
1404-04-06	259-2045-6-4	0107-4-6-SS	PS6-4C	140130
1404-06-06	259-2045-6-6	0107-6-6-SS	PS6-6C	140130
1404-08-08	259-2045-8-8	0107-8-8-SS	PS8-8C	140130
1404-12-12	259-2045-12-12	0107-12-12-SS	PS12C	140130
1404-16-16	259-2045-16-16	0107-16-16-SS	PS16C	140130
1404-20-20	259-2045-20-20	0107-20-20-SS	PS20C	140130
1404-24-24	259-2045-24-24	0107-24-24-SS	PS24C	140130
1404-32-32	259-2045-32-32	0107-32-32-SS	PS32C	140130

Share your knowledge of this product. Be the first to write a review »

### ABOUT US

Company Info  
Contact Us  
Careers  
Reference Center

### MY ACCOUNT

View Cart  
Sign-In  
Order Status

### PRODUCTS

Product Index  
Category Index

### HELPFUL INFO

Shipping & Returns  
Privacy Policy  
Terms & Conditions  
Warranty

### QUESTIONS? CALL OR TEXT US!

Tel: (866) 620-7320  
Email:  
sales@hydraulicsdirect.com

Copyright 52540 Hydraulics Direct

## FOLLOW US

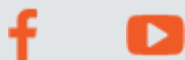

## TRUSTED SELLER

